

## HR093 Pages

This chart shows additional available pages.

To utilize a function on a page:

- Make sure the HR093 is set for that page.
- Find the command under that page's column.
- Push the HR093 button listed under "Button Label" to the right.

Names are color coded for multiple options.

Code #	Button Label	NEC Hex Code	Alt Hex Code	HR072: Normal Codes use page 3/ Alt use page 4	Misc Functions: Normal Codes use page 5	HR061/073: Alt Codes use page 6	C1100/D100 Discrete Inputs Normal page7/ Alt page 8	HR034/042/044: Normal Codes use page 9
Code #	Button Label	NEC Hex Code	Alt Hex Code	HR072 Remote Function Name	Legacy Remote Function Name	HR061/073 Remote Function Name	C1100/D100 Function Name	HR034 Function Name
1	-	00H	80H	-	-	-	-	-
2	> PLAY	01H	81H	> PLAY	-	> PLAY	> PLAY	> PLAY
3	>>  NEXT	02H	82H	>>  NEXT	-	>>  NEXT	>>  NEXT	>>  NEXT
4	<< BACK	03H	83H	<< BACK	-	<< BACK	<< BACK	<< BACK
5	*STOP	04H	84H	*STOP	-	*STOP	*STOP	*STOP
6	> PLAY / 1	05H	85H	-	ACC ON	-	MM PH	-
7	*STOP / 2	06H	86H	-	ACC OFF	-	MC PH	-
8	(Pause)	07H	87H	(Pause)	-	(Pause)	(Pause)	E
9	CD2 / 3 / SAT	08H	88H	-	-	CDR	MCT	SAT
10	LV / 4 / TV	09H	89H	-	-	SERVER	OPT1	TV
11	LV / Tape 2 / 5	0AH	8AH	SERVER	-	MM	5	LV
12	VCR / SAT / 6	0BH	8BH	D/A	-	INP DN	OPT3	VCR1
13	TV / 7 / VCR2	0CH	8CH	-	-	INP UP	COAX1	VCR2
14	DVD / VCR2 / 8	0DH	8DH	DVD	-	MC	COAX2	V-AUX
15	TRIM	0EH	8EH	TRIM	-	TRIM	TRIM	TRIM
16	PRESET	0FH	8FH	PRESET	-	PRESET	PRESET	PRESET
17	CD / 9	10H	90H	CD	-	CD	COAX3	CD1
18	CD2 / DVD / 0	11H	91H	CD2	-	DVD	AES/EBU	CD2
19	TUNER / CD	12H	92H	TUNER	-	TUNER	BAL1	TUNER
20	TAPE / VCR / CD2	13H	93H	-	-	D/A	BAL2	TAPE 1
21	TAPE2/TAPE/TUNER	14H	94H	MM	-	REC MON	BAL3	TAPE 2
22	VCR / PH/AUX	15H	95H	-	Old TAPE3	-	BAL4	-
23	SAT / VCR2	16H	96H	MC	Old VIDEO	-	BAL5	-
24	PH/AUX / TV	17H	97H	AUX	-	AUX	USB	PH/AUX
25	LEFT	18H	98H	LEFT	-	LEFT	LEFT	LEFT
26	UP	19H	99H	UP	-	UP	UP	UP
27	RIGHT	1AH	9AH	RIGHT	-	RIGHT	RIGHT	RIGHT
28	DOWN	1BH	9BH	DOWN	-	DOWN	DOWN	DOWN
29	SELECT	1CH	9CH	SELECT	-	SELECT	SELECT	SELECT
30	INFO / LV	1DH	9DH	INFO	-	INFO	BAL6	INFO
31	DISP	1EH	9EH	DISP	-	DISP	DISP	DISP
32	MENU	1FH	9FH	MENU	-	MENU	MENU	MENU
33	Power ON	40H	C0H	-	POWER (Cycle)	-	-	POWER (Cycle)
34	Power OFF / DVD	41H	C1H	-	SYSTEM OFF	-	UNBAL1	SYSTEM OFF
35	VOL UP	42H	C2H	VOL UP	-	VOL UP	VOL UP	VOL UP
36	VOL DOWN	43H	C3H	VOL DOWN	-	VOL DOWN	VOL DOWN	VOL DOWN
37	LEVEL UP	44H	C4H	LEVEL UP	-	LEVEL UP	LEVEL UP	SURR UP
38	LEVEL DOWN	45H	C5H	LEVEL DOWN	-	LEVEL DOWN	LEVEL DOWN	SURR DOWN
39	MUTE	46H	C6H	MUTE	-	MUTE	MUTE	MUTE
40	MODE	47H	C7H	MODE	-	MODE	EXIT	SP
41	BLUE BTN (SETUP)	48H	C8H	BLUE BTN	-	BLUE BTN (SETUP)	BLUE BTN (SETUP)	BLUE BTN (SETUP)
42	TAPE	49H	C9H	REC MON	TAPE MON	-	UNBAL2	-
43	TAPE2	4AH	CAH	-	TAPE MON2	-	-	-
44	Power ON	4BH	CBH	POWER ON	-	POWER ON	POWER ON	-
45	AM / TAPE2	4CH	CCH	-	SPEAKER 1	-	UNBAL3	-
46	FM / VCR	4DH	CDH	-	SPEAKER2	-	UNBAL4	-
47	LEVEL UP	4EH	CEH	-	INPUT UP	-	-	-
48	LEVEL DOWN	4FH	CFH	-	INPUT DOWN	-	-	-
49	1	50H	DOH	1	-	1	-	1
50	2	51H	D1H	2	-	2	-	2
51	3	52H	D2H	3	-	3	-	3
52	4	53H	D3H	4	-	4	-	4
53	5	54H	D4H	5	-	5	-	5
54	6	55H	D5H	6	-	6	-	6
55	7	56H	D6H	7	-	7	-	7
56	8	57H	D7H	8	-	8	-	8
57	9	58H	D8H	9	-	9	-	9
58	0	59H	D9H	0	-	0	-	0
59	<< (REW)	5AH	DAH	<< (REW)	-	<< (REW)	<< (REW)	SEEK DOWN
60	>> (FF)	5BH	DBH	>> (FF)	-	>> (FF)	>> (FF)	SEEK UP
61	BAND (REVIEW)	5CH	DCH	BAND (REVIEW)	-	BAND (REVIEW)	BAND (REVIEW)	REVIEW
62	AM (OUTPUT1)	5DH	DDH	AM (OUTPUT1)	-	AM (OUTPUT1)	AM (OUTPUT1)	AM
63	FM (OUTPUT2)	5EH	DEH	FM (OUTPUT2)	-	FM (OUTPUT2)	FM (OUTPUT2)	FM
64	Power OFF	5FH	DFH	POWER OFF	-	POWER OFF	POWER OFF	-

# McIntosh®

LEGENDARY PERFORMANCE™

## HR093 Remote Control Operation Guide



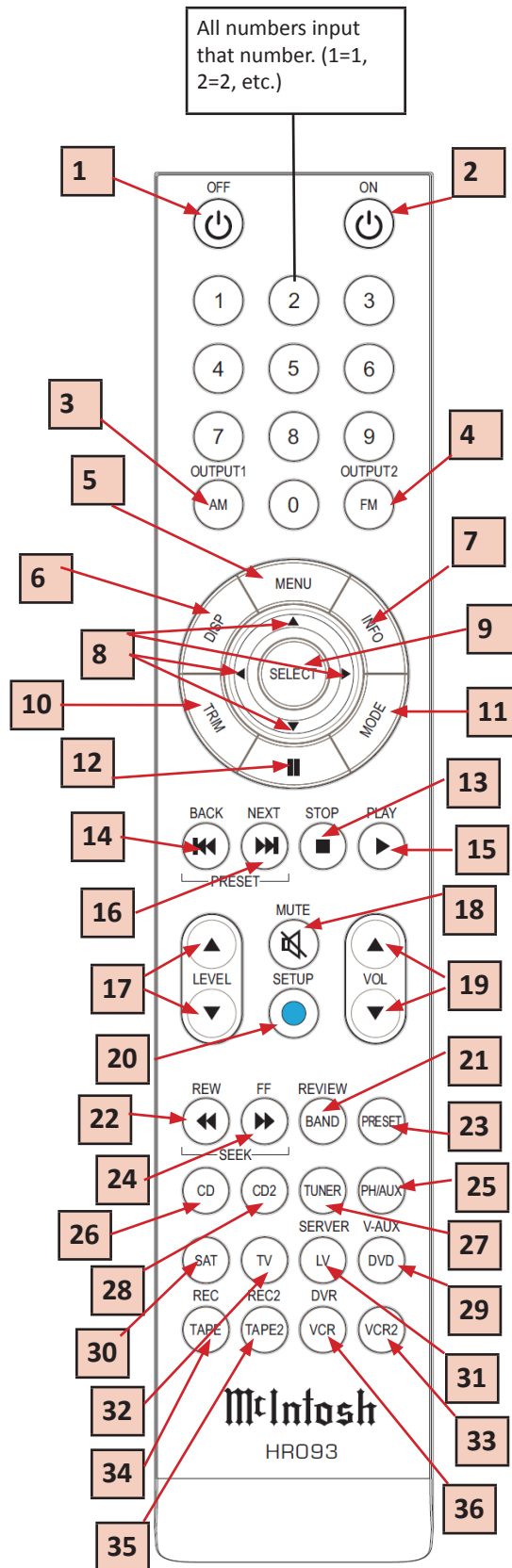

Remote  
Models

	HR093	HR034 HRL042 HR044 HR058 HR060 HR071	HR054 HR061 HR073 Alternate Code	HR070 HR072* HR070 Only	HR085*
1	Off	Off	Off	Off	Off
2	On	On	On	On	On
3	AM <b>Output1</b>	AM	AM	AM	AM <b>Output1</b>
4	FM <b>Output2</b>	FM	FM	FM	FM <b>Output2</b>
5	Menu	Menu	Menu	Menu	Menu
6	Display	Display	Display	Display	Display
7	Info	Info	Info	Info	
8	LeftUpDownRight	LeftUpDownRight	LeftUpDownRight	LeftUpDownRight	LeftUpDownRight
9	Select	Select	Select	Select	Select
10	Trim	Trim	Trim	Trim	Trim
11	Mode	Mode	Mode	Mode	Mode
12	Pause	Pause	Pause	Pause	
13	Stop	Stop	Stop	Stop	Stop
14	Back	Back	Back	Back	Back
15	Play	Play	Play	Play	Play
16	Next	Next	Next	Next	Next
17	Level up/down	Level up/down	Level up/down	Level up/down	Level up/down
18	Mute	Mute	Mute	Mute	Mute
19	Volume +/-	Volume +/-	Volume +/-	Volume +/-	Volume +/-
20	<b>Setup</b>	<b>2nd</b>	<b>2nd</b>	<b>2nd</b>	<b>Setup</b>
21	Band (Review)	Band	Band (+10)	Band	Band
22	Rewind	Channel Dn	Chnl Dn (Rew)	Channel Dn	Rewind
23	Preset	Menu	Preset	Preset	Preset
24	Fast Forward	Channel Up	Chnl Up (FF)	Channel Up	FF
25	PH/Aux	Phono/Aux	Aux	Aux	
26	CD	CD	CD	CD	
27	Tuner	Tuner	Tuner	Tuner	
28	CD2	CD2	CDR	CD2	
29	DVD (VAUX)	DVD	DVD	DVD	
30	SAT	SAT	Input Down	<b>SAT</b>	
31	LV (Server)	LV	Server	Server	
32	TV	TV	Input Up	<b>TV</b>	
33	VCR2	VCR2	MC		
34	Tape (REC)	Tape	VCR (DVR)	<b>REC</b>	
35	Tape2 (REC2)	Tape2	MM		
36	VCR (DVR)	VCR	D/A	<b>DVR</b>	

Since McIntosh equipment lasts many decades, and Remotes can be dropped, lost, or chewed by dogs, it's inevitable that some people will require a new Remote or two over time. There have been many McIntosh Remotes over the years, and not all of them are currently available. The HR093 has been designed to replace some older model Remotes while maintaining much of the functionality of the original Remote. Some differences are inevitable (Laser Disk anyone?). The chart to the left shows the button assignments of the HR093 compared to previous models.

### Installing Batteries

The HR093 requires two CR2032 Lithium Coin/Button Cell batteries which have been supplied and will occasionally need to be replaced.

**⚠ WARNING**

**DO NOT INGEST BATTERY, CHEMICAL BURN HAZARD**

The remote control supplied with this product contains a coin/button cell battery. If the coin/button cell battery is swallowed, it can cause severe internal burns in just 2 hours and can lead to death. Keep new and used batteries away from children. If the battery compartment does not close securely, stop using the product and keep it away from children. If you think batteries might have been swallowed or placed inside of the body, seek immediate medical attention.

Using a small flathead screw driver, or similar flat sturdy object, pry open the battery compartment found on the back of the HR093.

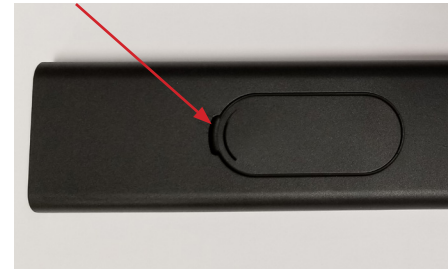

Install the CR2032 with the positive (+) side facing up in the slot sliding the battery under the small lip by the "+" symbol.

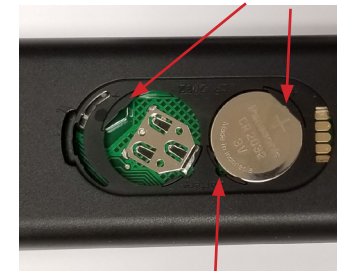

To remove battery, lift by inserting a small object in the small gap opposite the lip, and pry upwards. Dispose of the battery in accordance with the local regulations for lithium battery disposal.

### Changing Pages and Alternate Control Codes

The HR093 has nine "pages" of commands. Each page will use either "normal" or "alternate" IR hex codes. The default setup for the HR093 is Page 1 which uses Normal codes. Page 2 contains the same command set, but uses alternate codes. It may be necessary to use alternate codes if two units share the same control codes. Switching one unit to alternate codes will allow conflict free control of both units. The HR073 Remote uses alternate codes by default so the HR093 must be switched to alternate codes to replace that Remote.

The additional pages of the HR093 will allow buttons to send different commands. There are also additional pages containing some commands that have no direct button on the HR093. Using these pages will allow you to access additional commands, and use them to teach a learning Remote or control system. These codes and pages are listed on the chart on the back page of this guide.

To change the current page of the HR093, simultaneously hold the SELECT button and the desired page number for about 8 seconds. The light around the top left button will blink a number of times corresponding to the new page number. To return to normal control codes, hold SELECT and the number 1 button as just described. The light will blink once.

### Using the SETUP button

To access the secondary commands written in blue above some buttons, push and release the SETUP button (Blue Circle), then choose a command (namely OUTPUT1 or OUTPUT2).

### Questions?

If you need further technical assistance, please contact your dealer who may be more familiar with your particular setup including other brands. You can also contact McIntosh with additional questions or in the unlikely event of needing service.

McIntosh Laboratory, Inc.  
2 Chambers Street  
Binghamton, New York 13903  
(607) 723-3512

support@mcintoshlabs.com

The continuous improvement of its products is the policy of McIntosh Laboratory Incorporated who reserve the right to improve design without notice.

Printed in the U.S.A.